

REV	DESCRIPTION	DESIGN	DATE
A0	NEW RELEASE	Wudanping	2016/04/10
A1	Adjust flatness	Jiangjianyin	2020/06/18

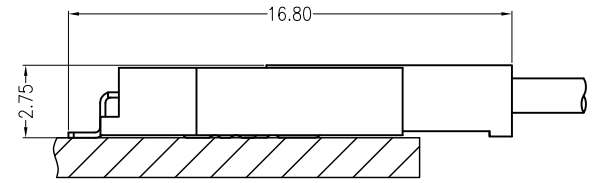

Assembly Layout

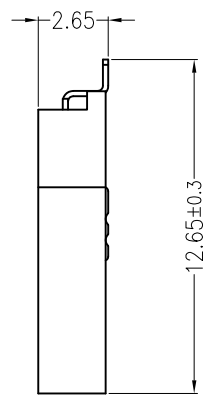
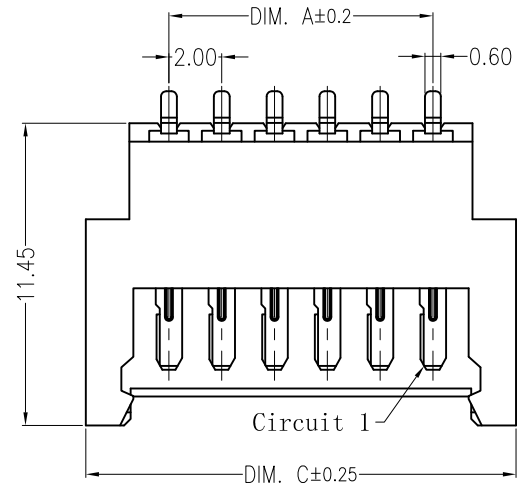
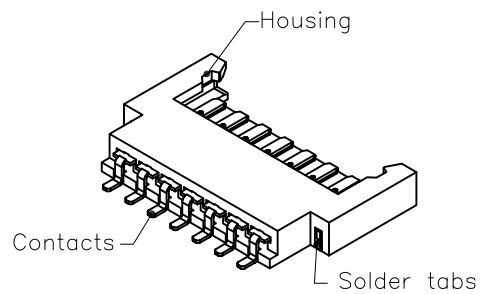
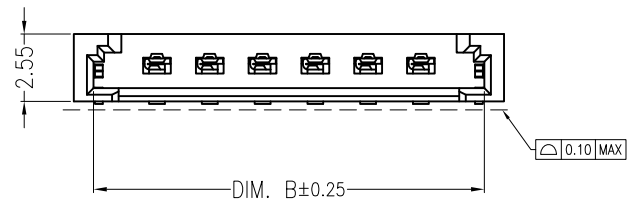

3D VIEWS

Specifications:

- Contact resistance: ≤20mΩ
- Insulation resistance: ≥1000MΩ
- Rated voltage: 125V AC DC
- Rated current: 2.0A AC DC
- Withstand voltage: 500V AC/minute
- Temperature range: -40℃ ~ +120℃
- Housing: LCP, UL94V-0, Natural
- Contacts: Phosphor Bronze/Matte Sn
- Solder tabs: Brass/Matte Sn

ORDER INFORMATION:

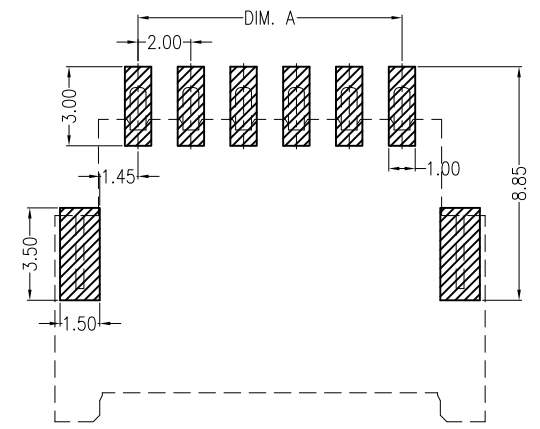
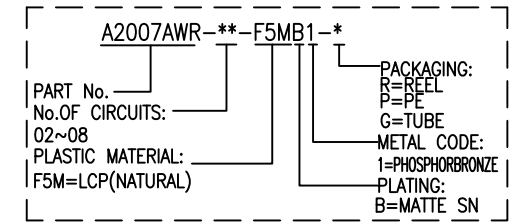

SUGGESTED PCB LAYOUT

Circuits	Dimensions (mm)		
	DIM. A	DIM. B	DIM. C
02	2.00	6.80	8.30
03	4.00	8.80	10.30
04	6.00	10.80	12.30
05	8.00	12.80	14.30
06	10.00	14.80	16.30
07	12.00	16.80	18.30
08	14.00	18.80	20.30

JKUN 温州健坤接插件有限公司
WENZHOU JKUN CONNECTOR CO.,LTD.

GENERAL TOLERANCE		USE:
X. ±0.50	X. ±5'	CUSTOMER
X.X ±0.30	X.X ±2'	APPD: Shaojinghe
X.XX ±0.20	X.XX ±1'	CHKD: Zenglingqing
⊕	∇	DR: Jiangjianyin
UNITS: mm		

TITLE: 2.00mm PITCH 90° WAFER SMT TYPE	
PART NO.:	
A2007AWR-**-F5MB1-*	
DWG NO.:	
JKUN/GCKH-0657	
SCALE 1 : 1	SHEET 1 / 1