

REV	DESCRIPTION	DESIGN	DATE
A	NEW RELEASE	Ryan	2021/07/07

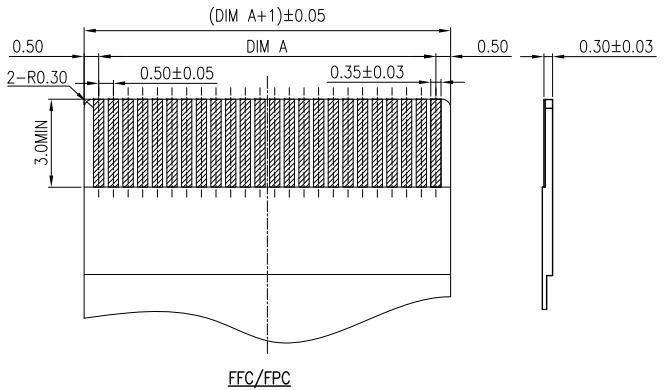
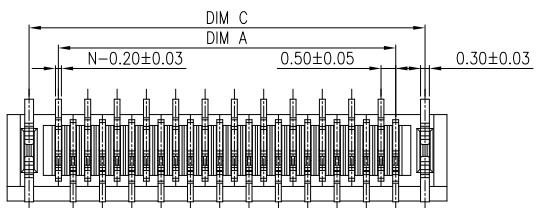
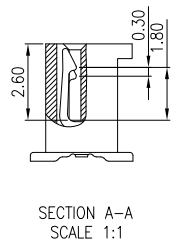
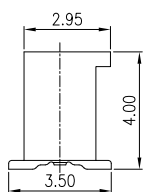
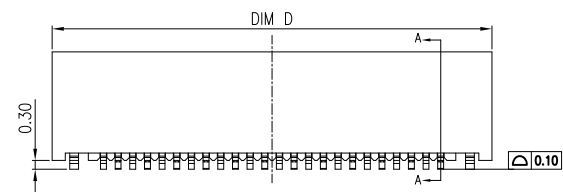
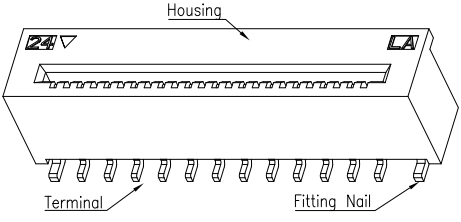

CKT	DIM A	DIM B	DIM C	DIM D	CKT	DIM A	DIM B	DIM C	DIM D
6	2.50	3.60	4.50	6.00	29	14.00	15.10	16.00	17.50
7	3.00	4.10	5.00	6.50	30	14.50	15.60	16.50	18.00
8	3.50	4.60	5.50	7.00	31	15.00	16.10	17.00	18.50
9	4.00	5.10	6.00	7.50	32	15.50	16.60	17.50	19.00
10	4.50	5.60	6.50	8.00	33	16.00	17.10	18.00	19.50
11	5.00	6.10	7.00	8.50	34	16.50	17.60	18.50	20.00
12	5.50	6.60	7.50	9.00	35	17.00	18.10	19.00	20.50
13	6.00	7.10	8.00	9.50	36	17.50	18.60	19.50	21.00
14	6.50	7.60	8.50	10.00	37	18.00	19.10	20.00	21.50
15	7.00	8.10	9.00	10.50	38	18.50	19.60	20.50	22.00
16	7.50	8.60	9.50	11.00	39	19.00	20.10	21.00	22.50
17	8.00	9.10	10.00	11.50	40	19.50	20.60	21.50	23.00
18	8.50	9.60	10.50	12.00	41	20.00	21.10	22.00	23.50
19	9.00	10.10	11.00	12.50	42	20.50	21.60	22.50	24.00
20	9.50	10.60	11.50	13.00	43	21.00	22.10	23.00	24.50
21	10.00	11.10	12.00	13.50	44	21.50	22.60	23.50	25.00
22	10.50	11.60	12.50	14.00	45	22.00	23.10	24.00	25.50
23	11.00	12.10	13.00	14.50	46	22.50	23.60	24.50	26.00
24	11.50	12.60	13.50	15.00	47	23.00	24.10	25.00	26.50
25	12.00	13.10	14.00	15.50	48	23.50	24.60	25.50	27.00
26	12.50	13.60	14.50	16.00	49	24.00	25.10	26.00	27.50
27	13.00	14.10	15.00	16.50	50	24.50	25.60	26.50	28.00
28	13.50	14.60	15.50	17.00					

Specifications:
 Housing: High temperature plastic UL94V-0; Color: natural
 Terminal: Copper alloy, Matte Tin/Gold
 Fitting Nail: Copper alloy, Matte Tin
 Product must comply HF RoHS specification
 Contact resistance: ≤30mΩ
 Insulation resistance: ≥100MΩ
 Rated voltage: 50V AC/DC
 Rated current: 0.5A AC/DC
 Withstand Voltage: 250V AC/minute
 Temperature Range: -25°C ~ +85°C

ORDER INFORMATION:

F0509AWN-**-F4M*1-*
 PART No. _____
 No. OF CIRCUITS: _____
 6~50
 PLASTIC MATERIAL: _____
 F4M=LCP(Natural)
 PACKAGING:
 R=REEL G=TUBE
 Metal code:
 1=Phosphor Bronze
 PLATING:
 B=Matte Tin
 C=Gold

JKUN 温州健坤接插件有限公司
 WENZHOU JKUN CONNECTOR CO.,LTD.

GENERAL TOLERANCE	USE:
X.X ±0.15	CUSTOMER
X.XX ±0.10	APPD: Shaojinghe
X.XXX ±0.05	CHKD: Shaojinghe
UNITS: mm	DR: Ryan

TITLE:
 FPC Pitch0.5 H4.0 NON-ZIF Conn. SMT Normal Type
 PART NO.:
 F0509AWN-**-F4M*1-*
 DWG NO.:
 JKUN-GCKH-
 SCALE: 1:1
 SHEET: 1/1